

PRODUCT INFORMATION PACKET

Model No: 056T34D5357
Catalog No: B193
3,3450,DP,56HZ,3/60/208-230/460
Fan and Blower



Regal and Marathon are trademarks of Regal Beloit Corporation or one of its affiliated companies.

©2018 Regal Beloit Corporation, All Rights Reserved. MC017097E



Nameplate Specifications

Output HP	3 Hp	Output KW	2.2 kW
Frequency	60 Hz	Voltage	208-230/460 V
Current	8.9-8.4/4.2 A	Speed	3450 rpm
Service Factor	1.15	Phase	3
Efficiency	84 %	Duty	Continuous
Insulation Class	B	Design Code	B
KVA Code	J	Frame	56HZ
Enclosure	Drip Proof	Overload Protector	Automatic
Ambient Temperature	40 °C	Drive End Bearing Size	6205
Opp Drive End Bearing Size	6205	UL	Recognized (Not Protector)
CSA	Y	CE	Y
IP Code	22		

Technical Specifications

Electrical Type	Squirrel Cage Induction Run	Starting Method	Across The Line
Poles	2	Rotation	Reversible
Mounting	Resilient Base	Motor Orientation	Horizontal
Drive End Bearing	Ball	Opp Drive End Bearing	Ball
Frame Material	Rolled Steel	Shaft Type	Single Special Extension
Overall Length	12.22 in	Frame Length	7.56 in
Shaft Diameter	0.625 in	Shaft Extension	2.28 in
Assembly/Box Mounting	F1 Only		
Outline Drawing	A-100573-756	Connection Diagram	A-EE7335

This is an uncontrolled document once printed or downloaded and is subject to change without notice. Date Created: 07/02/2018

100573

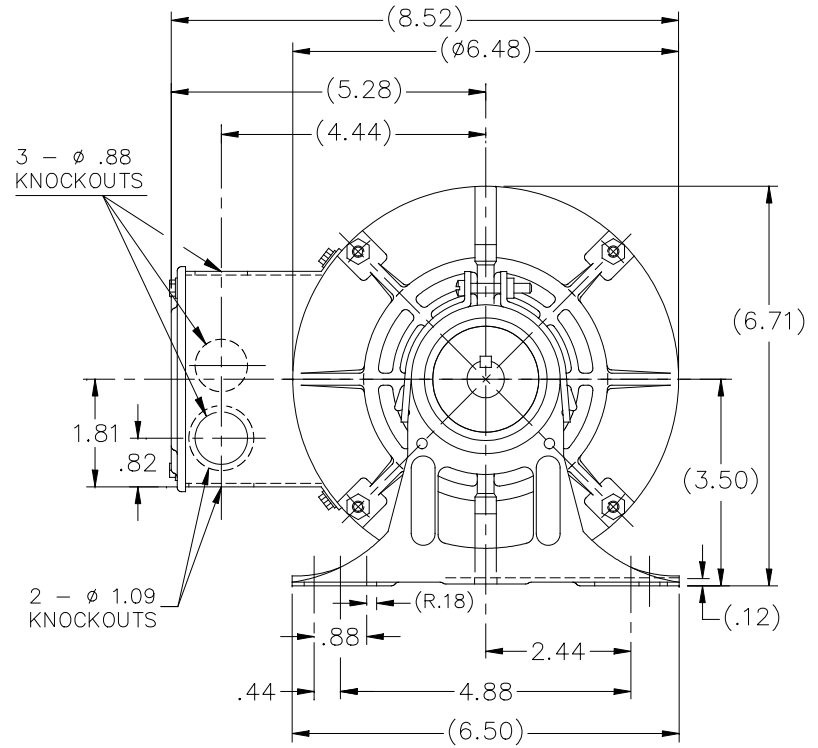
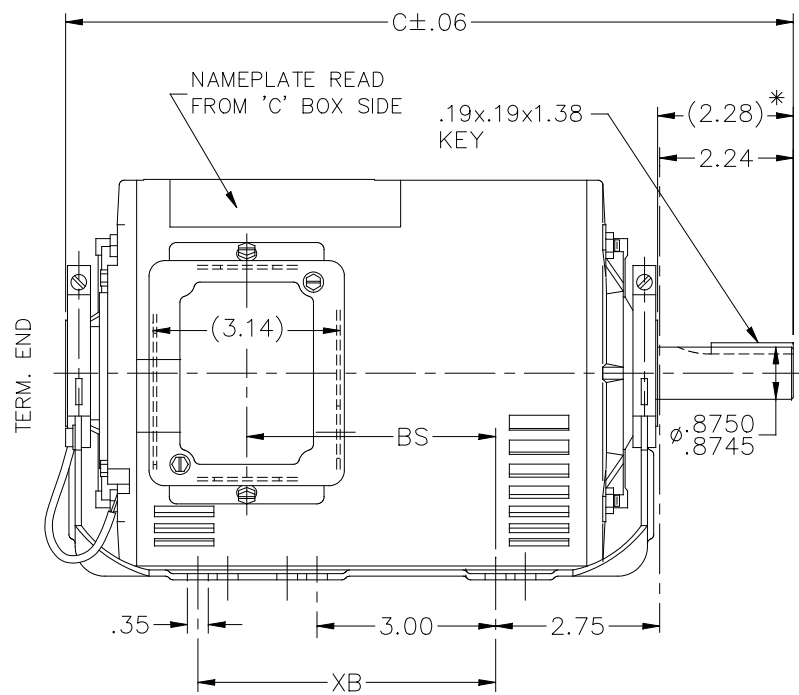

* DIMENSION IS FROM RESILIENT RING END CAP TO END OF SHAFT

DASH	FRAME	C	XB	BS	DASH	FRAME	C	XB	BS
656	56-65	11.22	0	3.18	856	56-85	13.22	5.00	5.18
706	"-70	11.72	0	3.68	906	"-90	13.72	5.00	5.68
756	"-75	12.22	5.00	4.18					
806	"-80	12.72	5.00	4.68					

NO.	REVISION	BY & DATE	CHK	ANG	±'	30"	TOLERANCES UNLESS SPECIFIED		MARATHON ELECTRIC	DRAWN SMC 02-17-1992		
							DEC.	INCHES				
5	REMOVED NOTE ON DRAWING	UD 06-13-2018								CHK ET 02-17-1992		
4	UPDATED DRAWING	RJW 03-28-2007		X		±.1				APPD MJ 02-17-1992		
3	REDRAWN IN AUTOCAD	TAT 09-01-2004	ML	XX		±.03				SCALE 3=8		
2	ADDED NOTE	CN 24378	PGK 06-11-1997		.XXX	±.005			TITLE OUTLINE	REF		
1	NEW DRAWING	3868949	SMC 02-17-1992		.XXXX	±.0005			56 FR. - BB - DR.PR. - RESIL. BASE			
									MAT'L.	FMF		
									FINISH	PREV		
THIS DRAWING IN DESIGN AND DETAIL IS OUR PROPERTY AND MUST NOT BE USED EXCEPT IN CONNECTION WITH OUR WORK ALL RIGHTS OF DESIGN AND INVENTION ARE RESERVED THIS IS AN ELECTRONICALLY GENERATED DOCUMENT - DO NOT SCALE THIS PRINT							RFP	CAD FILE 100573	SIZE A	DRAWING NO. 100573	PAGE OF 5	REV. 5
							DIST WP					

EE7335

HIGH VOLTAGE CONNECTIONS

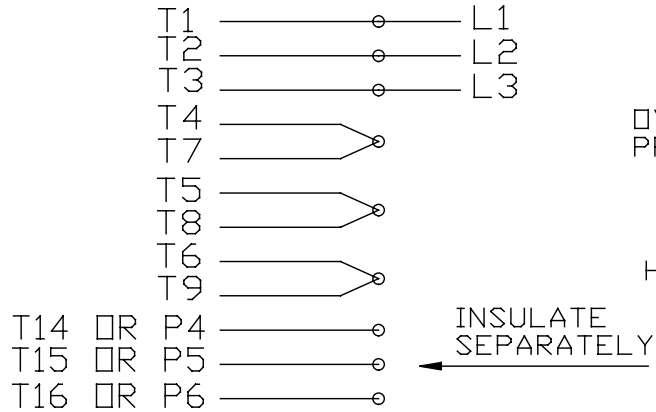

THREE PHASE - DUAL VOLTAGE MOTOR WITH OVERLOAD PROTECTOR

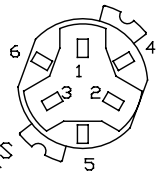

NOTE:
ACTUAL PROTECTORS
TERMINAL LOCATIONS
FOR LEAD CONNECTIONS

OVERLOAD
PROTECTOR
DISC
HEATER

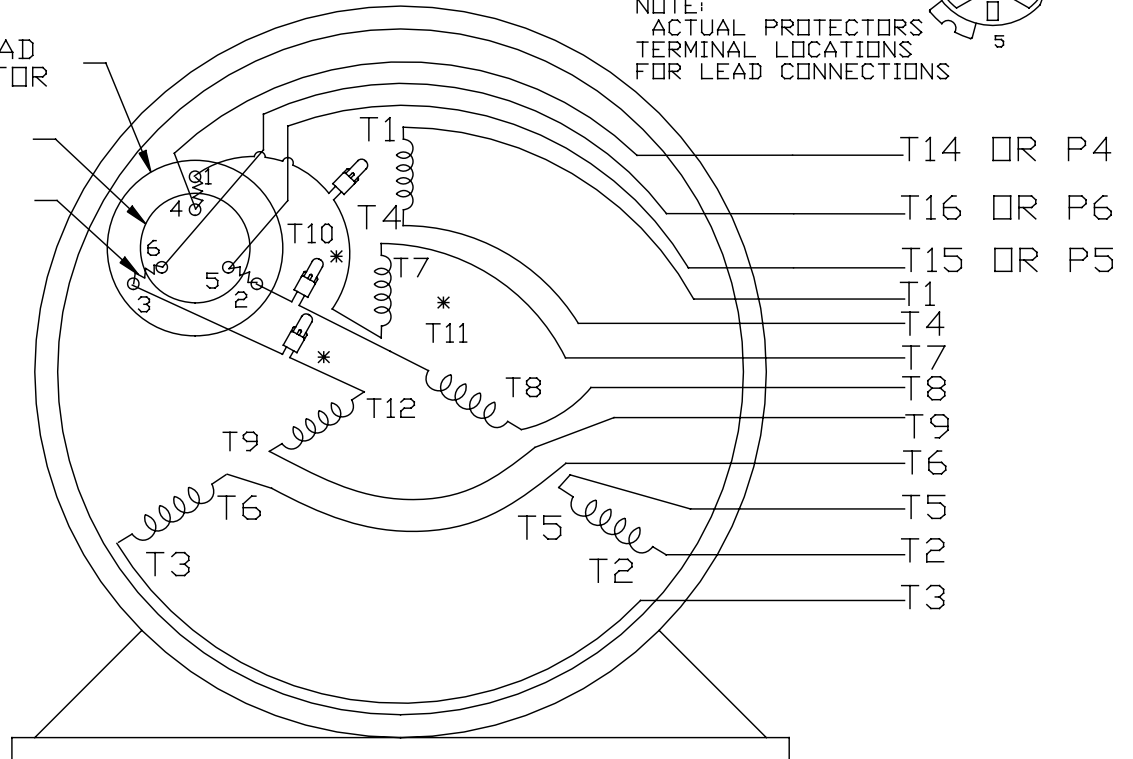

LOW VOLTAGE CONNECTIONS

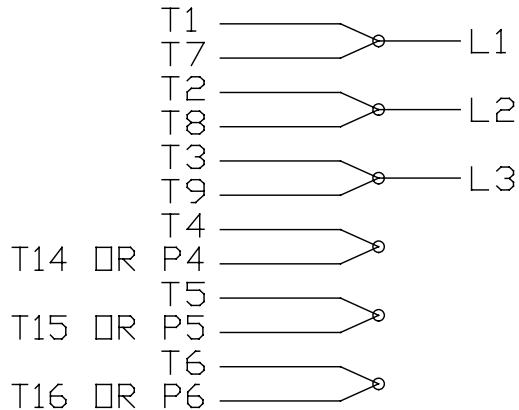

VIEW OF TERMINAL END

* USE PRESSURE CONNECTORS FOR MT2 PLANT ONLY

T2K
T4D
T6AN

NO.	REVISION	BY & DATE	CHK	TOLERANCES UNLESS SPECIFIED		FINISH	DRAWN	SCALE	REV.	
				DEC.	INCHES					
17	CHANGED LOGO FROM MARATHON TO REGAL	KIR 02/16/16	AB	DEC.	INCHES	Regal Beloit America, Inc.	KL	08-09-1993		
16	PRESSURE CONNECTORS QUANTITY WAS 6	PVR 10/29/13	GR	.X	±.1		CHK	ML	08/10/1993	
15	PRESSURE CONNECTORS ADDED	GR 03/04/13	SR	.XX	±.01		APPD	GK	08/10/1993	
14	ADDED ACTUAL PROECTOR VIEW CN 17481	KL 05/18/94		.XXX	±.005		TITLE		1=1	
13	REDRAWN IN AUTO CAD	KL 08/11/93		.XXXX	±.0005		3Ø-DUAL VOLT WITH OVERLOAD PROTECTO	REF		
				ANG	±1/2*	MAT'L.	FMF			
				RFP		FINISH	PREV			
				DIST		CAD FILE	EE7335	SIZE	DRAWING NO.	
						A	EE7335		17	

THIS DRAWING IN DESIGN AND DETAIL IS OUR PROPERTY AND MUST NOT BE USED EXCEPT IN CONNECTION WITH OUR WORK ALL RIGHTS OF DESIGN AND INVENTION ARE RESERVED THIS IS AN ELECTRONICALLY GENERATED DOCUMENT - DO NOT SCALE THIS PRINT

